

Wire-free Indoor Surveillance Camera

The next generation of security & surveillance devices

Portable & Wire-free, no cables or power costs!

Patented low power design, delivering up to 9 weeks with the standard battery option

Optionally integrate BlueEye into your existing alarm system

Half the cost ... twice the image quality

BlueEye

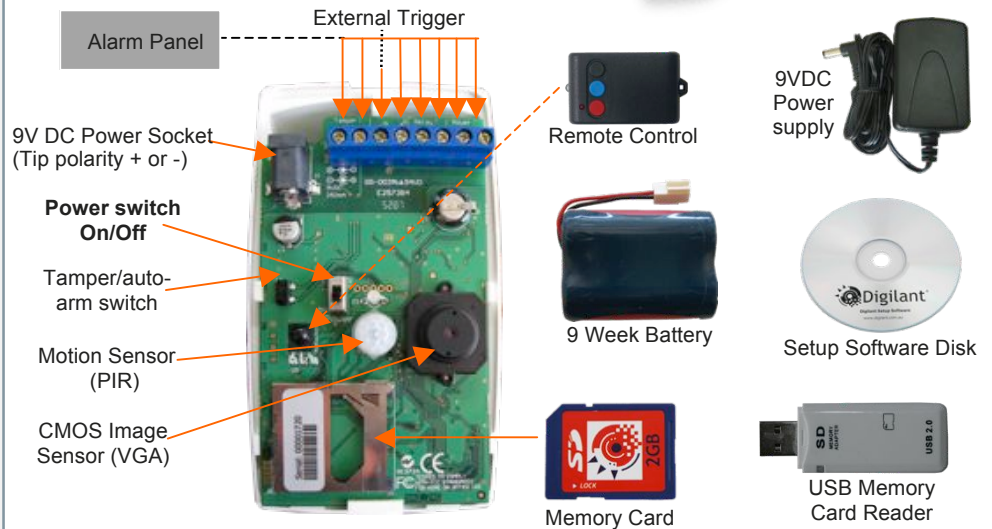

Image Type	Colour or Monochrome, JPEG compressed VGA (640 x 480 pixels), QVGA (320 x 240)
Camera Lens	3.7mm, AOV: 54°(H) x 39deg°(V)
Image Sensor Sensitivity	Colour: 3.8 V/Lux-sec Mono: 3.0 V/Lux-sec
Motion Sensor (PIR)	Range: 0-5 m (16') (minimum), 0-12 m (39') (typical) Field of View: 100° horizontal, 80° vertical
Memory Card	MMC™ Card (v4.2) or SD™ Card (v1.1), FAT16 file format
Approximate Image Capacity	2GB Memory Card: VGA: 32,000 images, QVGA: 65,000 images
External Power Supply	9VDC to 13.8VDC, 250 mA (Plug tip polarity + or -)
Internal Battery Capacity	9 week standby battery: Lithium Ion, 3.7V 3000mAh
Photo-Relay Specifications	280VDC, 100mA
Power Consumption	Standby: 1.9 mA Running: 100 mA Charging: 200 mA
Case Dimensions & Rating	116 H x 67 W x 55 D mm (4.6" x 2.6" x 2.2")
Weight	172g (6oz) – Including 9 week battery
Operating Temperature	-20°C to +60°C (-4°F to 140°F)
PC Software Requirements	Windows 2000 (SP4), Windows XP (SP2), Windows Vista, Windows 7



Mi5
SECURITY

New Zealand 0800 111 309
Australia +61 2 9241 1537
International +64 9 3774 309
www.mi5security.com
info@mi5security.com

Eye Series products from Mi5:

BlueEye (indoor camera), BlueEye Secure (secure SS housing), BlueEye Alert (with siren/strobe), BlueEye for Alarms, RedEye (outdoors), RedEye DayNight (with night vision), RedEye Wireless (with cellular modem), RedEye Extreme (low maintenance wireless camera), PatrolEye and industry products including VendingEye & OEM kits